

BACK ON TRACK PHYSIOTHERAPY, COROWA – PARKING STUDY

Project Background

Spotto CONSULTING completed a parking study in Sanger Street, Corowa, for Back on Track Physiotherapy.

The site was entirely occupied by a commercial building, and had no off-street parking. Working within the existing footprint, the development involved internal works on the building to provide a physiotherapy clinic, including consultation rooms, exercise space and office/admin facilities.

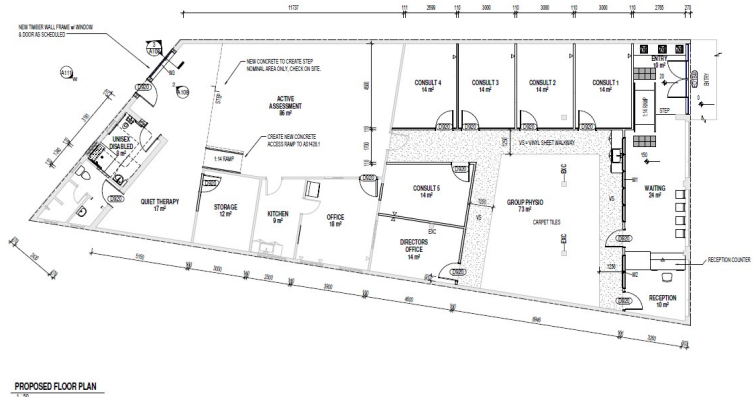

The Spotto CONSULTING Approach

The site did not have enough on-site car parks to meet the requirements of the local planning scheme. Spotto CONSULTING completed a parking study of the site and nearby parking that looked at the usage of public parking across the day.

Our approach centred on the people who would be using the facility (staff and customers), and people who might be affected by the development (such as businesses using nearby on-street car parks). We found there was adequate parking for customers on-street in front of the building, while staff could be catered for through minor on-street works (linemarking) at the rear.

The Outcome

Spotto CONSULTING's formal report that accompanied the submission to Council was well-received and the application was approved. The objectives of the local planning scheme were met: there was enough parking for staff and customers without adverse impacts on the surrounding area.

The project allowed what was a vacant building in a regional town centre to be used by a growing business, providing employment opportunities and necessary services to the local community.

Spotto CONSULTING

Spotto CONSULTING is an independent firm with expertise in traffic engineering, transport planning and road safety. Our focus is on solutions that are people-oriented.

For more information on how we can help you, contact us:

Steven Swann

Mob: 0455 11 77 82

Spotto CONSULTING

E: steven.swann@spottoconsulting.com.au